

REPORT ON DUMP SAMPLING

At the

BLACK DOME MINE

CLINTON M.D., British Columbia

Prepared for:

J-Pacific Gold Inc.
Suite 1440-1166 Alberni St.
Vancouver, B.C.
Canada. V6E 3Z3



By:

M. A. Mitchell, P.Eng.
Mitchell Geologic Services Inc.
Suite 1028-470 Granville St.
Vancouver, B.C.
Canada. V6C 1V5
e-mail marvingeol@hotmail.com

January 8, 2002

1.0 INTRODUCTION

From September 25 to September 27, 2001 a programme of mine dump sampling was performed on the Blackdome Mine, Clinton M.D., British Columbia.

The purpose of this programme was to assess as many of the mine dumps as possible to see if any of the dumps had economic grades or close to economic grades in gold. The company's philosophy is, that if enough economic grade mineralization is found above ground in these mine dumps, the tailings pond and in open pit potential around outcropping veins and breccia zones, the mill may be re-started using this material until additional underground reserves and resources can be found and developed and the mine can be re-opened and when the price of gold starts going up.

2.0 DESCRIPTION OF WORK

It was planned to rent a large enough back-hoe to trench across the dumps, and then manually sample the walls of the trenches vertically from top to bottom along measured intervals, breaking the samples where there was a gross change in rock type. (mineralization to waste or waste to mineralization).

It was found that the back-hoe was too small to provide the digging power to effectively dig the trenches deep enough to assess most of the dump volume.

Then, it was decided to dig a number of small holes with the back-hoe on regular intervals on the surface of the dumps. These holes ranged from a metre to a metre and one half deep and about a meter in horizontal cross section. Samples were then taken by dragging the back-hoe bucket up each side of the hole and dumping the sampled material on a plastic tarpaulin. Samples were then taken by hand from each pile and sent to ALS-Chemex Labs in North Vancouver.

A total of 72 samples were taken from 36 pits dug on 7 mine dumps, roads or ramps.

3.0 RESULTS OF WORK

The assay returns are presented in table 1. Samples that returned values of 0.03 opt gold and above are shown in red in the table. These samples were sent in for re-assay for gold using a 1,000 g wet screen fire assay. The wet screening was done at 75 micron (μ). Duplicate assays were done on the undersize fraction and one assay was done on the entire oversize fraction. The total gold content was calculated, individual assays and weight fractions are reported in table 2. (Taken from the ALS-Chemex assay certificates which are included in appendix A).

This procedure was used to:

- Check the assays for accuracy and,
- The screening was used to ascertain there was whether any difference in the assays in the large vs. small fractions.

The data included in table 2 is re-presented in table 3 with a conversion from Au g/tonne to Au oz/tonne.

TABLE 1 BLACK DOME DUMP SAMPLES

Sample #	Weight (kg)	Grade Oz/T	Area	Line	PIT	Depth(m)	Description
323801	4.66	0.0255	REDBIRD DUMP	1	1-S	2	Mainly Volc. Minor Qtz.
323802	5.52	0.0102	REDBIRD DUMP	1	1-N	2	50/50 Qtz. Volc.
323803	4.18	0.0066	REDBIRD DUMP	1	2-S	2	Mainly Volc.
323804	4.36	0.0009	REDBIRD DUMP	1	2-N	2	Mainly Volc.
323805	3.66	0.0027	REDBIRD DUMP	1	3-S	1.5	Mainly Volc.
323807	4.04	0.0045	REDBIRD DUMP	1	3-N	1.5	Mainly Volc.
323808	5.16	0.063	REDBIRD DUMP	2	1-S	2	Red Altrn + Qtz
323809	5.12	0.0333	REDBIRD DUMP	2	1-N	2	Red Altrn + Qtz
323810	4.66	0.0045	REDBIRD DUMP	2	2-S	2	25% Qtz. + Volc.
323811	2.92	0.0051	REDBIRD DUMP	2	2-N	2	Mainly Volcanics top 0.3m red
323813	3.04	0.0099	REDBIRD DUMP	2	3-S	1.5	Mainly Volcanics top 0.3m red
323814	3.76	0.0051	REDBIRD DUMP	2	3-N	1.5	Mainly Volcanics top 0.3m red
323815	3.82	0.0285	REDBIRD DUMP	3	1-S	2	Orange-red material
323816	5.86	0.0234	REDBIRD DUMP	3	1-N	2	Orange-red material
323818	5.08	0.0066	REDBIRD DUMP	3	2-S	2	Volc. 10% Qtz.
323819	4.94	0.0102	REDBIRD DUMP	3	2-N	2	Volc. 10% Qtz
323820	5.14	0.0042	REDBIRD DUMP	3	3-S	2	Volc. 10% Qtz.
323821	4.5	0.0069	REDBIRD DUMP	3	3-N	2	Volc. 10% Qtz
323822	5.54	0.0033	1960 South Dump		1-S	1.5	White Rhy. -minor Qtz.
323823	4.68	0.0063	1960 South Dump		1-N	1.5	White Rhy. -minor Qtz.
323825	5.56	0.2691	1960 South Dump		2-S	2	White Rhy. -minor Qtz.
323826	5.6	0.2217	1960 South Dump		2-N	2	White Rhy. -minor Qtz.
323827	5.76	0.0216	1960 South Dump		3-S	1	White Rhy. -minor Qtz.
323828	5.42	0.0273	1960 South Dump		3-N	1	White Rhy. -minor Qtz.
323829	6.16	0.0108	1960 South Dump		4-S	1.5	White Rhy. -minor Qtz.
323830	5.9	0.0066	1960 South Dump		4-N	1.5	White Rhy. -minor Qtz.
323831	6	0.0015	1960 South Dump		5-S	1.5	White Rhy. -minor Qtz.
323833	4.96	0.0075	1960 South Dump		5-N	1.5	White Rhy. -minor Qtz.
323834	5.82	0.1047	1960 South Dump		6-S	1.5	White Rhy. -minor Qtz.
323835	5.52	0.0393	1960 South Dump		6-N	1.5	White Rhy. -minor Qtz.
323836	5.88	0.027	1960 South Dump		7-S	1.5	White Rhy. -minor Qtz.
323837	5.9	0.0081	1960 South Dump		7-N	1.5	White Rhy. -minor Qtz.
323838	6.1	0.0024	1960 South Dump		8-S	1	White Rhy. -minor Qtz.
323839	5.10	0.0034	1960 South Dump		8-N	1	White Rhy. -minor Qtz.

TABLE 1 (Cont.) BLACK DOME DUMP SAMPLES P. 2

Sample #	Weight (kg)	Grade Oz/T	Area	Line	PIT	Depth(m)	Description
323878	6.18	0.0042	1960 South Dump		9-S	1.5	Rhyolite
323879	5.24	0.0213	1960 South Dump		9-N	1.5	Rhyolite
323880	6.66	0.0066	1960 South Dump		10-S	1.5	Rhyolite
323881	4.3	0.0051	1960 South Dump		10-N	1.5	Rhyolite
323841	5.74	0.0015	Crusher Ramp	west	1-N	1.5	Andesite
323842	7.44	0.4122	Crusher Ramp		1-S	1.5	Andesite
323843	7.2	0.0099	Crusher Ramp		2-N	1.5	Andesite
323844	7.14	0.7011	Crusher Ramp		2-S	1.5	Andesite
323845	7.06	0.0066	Crusher Ramp		3-N	1.5	Andesite
323846	6.72	0.0027	Crusher Ramp		3-N	1.5	Andesite
323849	7.08	0.0342	1920 Dump		1-N	1.5	Andesite
323850	5.8	0.0363	1920 Dump		1-S	1.5	Andesite
323851	6.38	0.075	1920 Dump		2-N	1.5	Mixed Rhy & Qtz
323852	6.56	0.0657	1920 Dump		2-S	1.5	Mixed Rhy & Qtz
323853	7.66	0.0792	1920 Dump		3-N	1.5	Mixed Rhy & Qtz
323854	6.98	0.0354	1920 Dump		3-S	1.5	Mixed Rhy & Qtz
323855	7.22	0.0177	1920 Dump		4-N	1.5	Mainly Andesite
323857	7.86	0.0255	1920 Dump		4-S	1.5	Mainly Andesite
323858	6.68	0.0213	1920 Dump		5-N	1.5	Mainly Andesite
323859	6.22	0.0036	1920 Dump		5-S	1.5	Mainly Andesite
323860	6.14	0.0027	Generator Clearing		1-E	1.5	Mainly rusty And. & Qtz
323861	5.8	0.0015	Generator Clearing		1-W	1.5	Mainly rusty And. & Qtz
323862	6.26	0.0039	Generator Clearing		2-E	0.5	Mainly rusty And. & Qtz
323863	5.48	0.0057	Generator Clearing		2-W	0.5	Mainly rusty And. & Qtz
323864	5.3	0.0012	Generator Clearing		3-E	1.5	Mainly rusty And. & Qtz
323865	5.16	0.0006	Generator Clearing		3-W	1.5	Mainly rusty And. & Qtz
323867	5.9	0.0057	Generator Clearing		4-E	2	Mainly rusty And. & Qtz
323868	6.72	0.006	Generator Clearing		4-W	2	Mainly rusty And. & Qtz
323869	5.96	0.0114	Generator Clearing		5-E	2	Mainly rusty And. & Qtz
323870	6.14	0.0156	Generator Clearing		5-W	2	Mainly rusty And. & Qtz
323871	6.76	0.0147	Generator Clearing		6-E	2	Mainly rusty And. & Qtz
323872	6.36	0.0096	Generator Clearing		6-W	2	Mainly rusty And. & Qtz

TABLE 1 (Cont.) BLACKDOME DUMP SAMPLES P. 3

Sample #	Weight (kg)	Grade Oz/T	Area	Line	PIT	Depth(m)	Description
323873	5.54	0.0546	Mill Road-Ramp		1-E	1.5	Mainly Andesite
323874	6.54	0.0219	Mill Road-Ramp		1-W	1.5	Mainly Andesite
323875	4.76	0.0231	Mill Road-Ramp		2-E	1.5	Mainly Andesite
323876	5.84	0.0063	Mill Road-Ramp		2-W	1.5	Mainly Andesite
323882	5.74	0.0066	1960 N. Portal		1-N	1.5	Mixed Andesite & Qtz
323883	5.28	0.0054	1960 N. Portal		1-S	1.5	Mixed Andesite & Qtz
323884	6.12	0.0036	1960 N. Portal		2-N	1.5	Mixed Andesite & Qtz
323885	5.18	0.0006	1960 N. Portal		2-S	1.5	Mixed Andesite & Qtz

TABLE 2 RERUNS

Sample #	Au total g/tonne	Au avg. g/tonne	Au mg	Wt - 75µm Grams	Wt + 75µm grams	Au(1) g/tonne	Au(1) g/tonne
323825	4.93	4.29	0.698	1059	5.27	4.33	4.25
323826	3.82	2.18	1.731	1044	5.83	2.3	2.05
323834	10.02	7.43	2.653	10.02	5.66	7.27	7.58
323835	2.5	1.19	1.247	941	7.36	1.2	1.18
323841	0.33	27.0	0.056	888	5.34	0.3	0.24
323842	0.17	14.0	0.032	947	3	0.14	0.14
323843	1.05	0.8	0.225	870	7.49	0.79	0.82
323844	16.69	6.51	9.642	943	2.39	6.88	6.13
323849	0.39	0.37	0.024	927	4.84	0.3	0.44
323850	0.13	0.12	0.013	884	4.13	0.1	0.13
323853	5.26	3.67	1.652	1018	5.5	3.7	3.64
323854	0.61	0.49	0.111	951	3.6	0.49	0.49

TABLE 3 RERUN CONVERSIONS

Sample #	Au total g/tonne	Au total oz/tonne	Au total g/tonne	Au avg. g/tonne	Au avg. oz/tonne	Au mg	Wt - 75µm grams	Wt + 75µm grams	Au-(1) g/tonne	Au-(2) g/tonne	Au-(1) Oz/tonne
323825	4.93	0.153	4.29	0.133	0.698	1059	5.27	4.33	4.25	0.135	
323826	3.82	0.119	2.18	0.068	1.731	1044	5.83	2.3	2.05	0.071	
323834	10.02	0.311	7.43	0.231	2.653	10.02	5.66	7.27	7.58	0.226	
323835	2.5	0.077	1.19	0.037	1.247	941	7.36	1.2	1.18	0.037	
323841	0.33	0.010	0.27	0.008	0.056	888	5.34	0.3	0.24	0.009	
323842	0.17	0.005	0.14	0.004	0.032	947	3	0.14	0.14	0.004	
323843	1.05	0.032	0.8	0.002	0.225	870	7.49	0.79	0.82	0.025	
323844	16.69	0.519	6.51	0.202	9.642	943	2.39	6.88	6.13	0.214	
323849	0.39	0.012	0.37	0.011	0.024	927	4.84	0.3	0.44	0.009	
323850	0.13	0.004	0.12	0.004	0.013	884	4.13	0.1	0.13	0.003	
323853	5.26	0.163	3.67	0.114	1.652	1018	5.5	3.7	3.64	0.115	
323854	0.61	0.019	0.49	0.015	0.111	951	3.6	0.49	0.49	0.015	

TABLE 4 ASSAY COMPARISONS

Sample #	Grade Oz/T table 1	Grade Oz/tonne conv.	Au total g/tonne	Au total oz/tonne conv.	Au avg. g/tonne	Au avg. oz/tonne	Au mg	Wt - 75µm grams	Wt + 75µm grams	Au-(1) g/tonne	Au-(2) g/tonne	Au-(1) Oz/tonne
323825	0.2691	0.2440	4.93	0.153	4.29	0.133	0.698	1059	5.27	4.33	4.25	0.135
323826	0.2217	0.2010	3.82	0.119	2.18	0.068	1.731	1044	5.83	2.3	2.05	0.071
323834	0.1047	0.0949	10.02	0.311	7.43	0.231	2.653	10.02	5.66	7.27	7.58	0.226
323835	0.0393	0.0356	2.5	0.077	1.19	0.037	1.247	941	7.36	1.2	1.18	0.037
323841	0.0015	0.0014	0.33	0.010	0.27	0.008	0.056	888	5.34	0.3	0.24	0.009
323842	0.4122	0.3739	0.17	0.005	0.14	0.004	0.032	947	3	0.14	0.14	0.004
323843	0.0099	0.0089	1.05	0.032	0.8	0.002	0.225	870	7.49	0.79	0.82	0.025
323844	0.7011	0.6359	16.69	0.519	6.51	0.202	9.642	943	2.39	6.88	6.13	0.214
323849	0.0342	0.0310	0.39	0.012	0.37	0.011	0.024	927	4.84	0.3	0.44	0.009
323850	0.0363	0.0329	0.13	0.004	0.12	0.004	0.013	884	4.13	0.1	0.13	0.003
323853	0.0792	0.0718	5.26	0.163	3.67	0.114	1.652	1018	5.5	3.7	3.64	0.115
323854	0.0354	0.0321	0.61	0.019	0.49	0.015	0.111	951	3.6	0.49	0.49	0.015

Table 4 is a re-presentation of the data from table 1 compared with converted data from table 3. Both columns are outlined in red.

For reference, $\text{g/tonne} / 32.151\text{g/Oz} = \text{Oz/tonne}$
 $\text{Oz/T} \times 0.907 \text{ T/tonne} = \text{Oz/tonne}$

3.0 CONCLUSIONS

A review of the data as outlined in table 4 shows that there is a rough correlation between the original assay grades and the screened grades on samples above 0.03 Oz/ton. There were two exceptions to this rough correlation—sample 323834(1) and sample 323842(2) where (1) the first sample was about one third of the screened duplicate and (2) where the first sample was 30 times the value of the screened duplicate.

The exceptions are probably a consequence of the pronounced “nugget effect” in the Blackdome mineralization. It should be noted that the amount of re-assayed samples was only twelve, and not a truly representative population.

A comparison of arithmetic averages for the third column versus the fifth column gave the following values, 0.1469 Oz/tonne vs. 0.1186 Oz/tonne. One might expect that a mine grade for these dumps would be in the 0.05 to 0.06 Oz/tonne range.

The distribution of the more economic portions of the mineralization is mainly from the 1920 dump and the crusher ramp with other values coming from two out of eight pits on the 1960 south dump. All of the other dumps produced low and spotty assay results.

Three areas that were not sampled were the area near the number one pit above the 1960 south portal, the South West and Watson veins. These areas although reclaimed should hold promise for additional low grade mineralization.

The volume of the dumps was not measured due to time constraints but an estimate of the volume of the dumps should be in the order of 20,000 to 25,000 tonnes.

Rough sketches of the dump areas are included with this brief report in appendix B.

The results of this brief sample program indicate that there is probably enough low grade mineralization in the within the Black dome dumps to warrant further sampling and that an asset may be there that possibly could be used to “run in” the concentrator should the price of gold make re-opening the Black dome Mine feasible.

4.0 RECOMMENDATIONS

The following recommendations should be carried out this next summer as funds become available.

(1) Rent a bigger excavator to cut trenches through the dumps for samples as previously described..

(2) In addition to the main dumps of immediate interest, the South West and the Watson veins should be sampled to assess their potential.

- (3) Try screening the material from the dumps and see if most of the gold is contained in one fraction or another.
- (4) Start a resource calculation for the Giant Vein open pit and proceed with the drilling of the tailings pond.
- (5) Prepare a budget for the above work.

Respectfully submitted,

January 8, 2002



A handwritten signature in cursive script, reading "Marvin A. Mitchell". The signature is written over a circular professional engineer's seal.

Marvin A. Mitchell, P.Eng.

APPENDIX A

ALS Chemex

Aurora Laboratory Services Ltd.
 Analytical Chemists * Geochemists * Registered Assayers
 212 Branksbank Ave., North Vancouver
 British Columbia, Canada V7J 2C1
 PHONE: 604-984-0221 FAX: 604-984-0218

To: J-PACIFIC GOLD INC.
 1440 - 1166 ALBERNI ST.
 VANCOUVER, BC
 V6E 3Z3

Project: BLACK DOME
 Comments: ATTN: NICK FERRIS CC: MARVIN MITCHELL

Page Number : 1
 Total Pages : 2
 Certificate Date : 17-OCT-2001
 Invoice No. : 10126284
 P.O. Number :
 Account : MVT

CERTIFICATE OF ANALYSIS A0126284

SAMPLE	PREP CODE	Weight KG	Air oz/ton							
323801	94139402	4.66	0.0255							
323802	94139402	5.52	0.0102							
323803	94139402	4.18	0.0066							
323804	94139402	4.36	0.0009							
323805	94139402	3.66	0.0027							
323807	94139402	4.04	0.0045							
323808	94139402	5.16	0.0630							
323809	94139402	5.12	0.0333							
323810	94139402	4.65	0.0045							
323811	94139402	3.92	0.0051							
323813	94139402	3.04	0.0099							
323814	94139402	3.76	0.0051							
323815	94139402	3.82	0.0285							
323816	94139402	5.86	0.0234							
323818	94139402	5.08	0.0066							
323819	94139402	4.94	0.0102							
323820	94139402	5.14	0.0042							
323821	94139402	4.50	0.0069							
323822	94139402	5.54	0.0033							
323823	94139402	4.68	0.0063							
323825	94139402	5.56	0.2691							
323826	94139402	5.60	0.2217							
323827	94139402	5.76	0.0216							
323828	94139402	5.42	0.0273							
323829	94139402	6.16	0.0108							
323830	94139402	5.90	0.0066							
323831	94139402	6.00	0.0015							
323832	94139402	4.96	0.0075							
323834	94139402	5.82	0.1047							
323835	94139402	5.52	0.0393							
323836	94139402	5.88	0.0270							
323837	94139402	5.90	0.0081							
323838	94139402	6.10	0.0024							
323839	94139402	5.10	0.0039							
323841	94139402	5.74	0.0015							
323842	94139402	7.44	0.6122							
323843	94139402	7.20	0.0099							
323844	94139402	7.14	0.7011							
323845	94139402	7.06	0.0066							
323846	94139402	6.72	0.0027							

CERTIFICATION

(Signature)

ALS Chemex

Aurora Laboratory Services Ltd
 Analytical Chemists • Geochemists • Registered Assayers
 212 Brookbank Ave., North Vancouver
 British Columbia, Canada V7J 2C1
 PHONE: 604-964-0221 FAX: 604-964-0218



To: J-PACIFIC GOLD INC.
 1440 - 1166 ALBERNI ST.
 VANCOUVER, BC
 V6E 3Z3

Project: BLACK DOME
 Comments: ATTN: NICK FERRIS CC: MARVIN MITCHELL

Page Number : 2
 Total Pages : 2
 Certificate Date: 17-OCT-2001
 Invoice No. : 1D126284
 P. O. Number :
 Account : MYT

CERTIFICATE OF ANALYSIS A0126284

SAMPLE	PREP CODE	Weight Kg	Au oz/ton						
323849	94139402	7.08	0.0342						
323850	94139402	5.80	0.0363						
323851	94139402	6.38	0.0750						
323852	94139402	6.56	0.0657						
323853	94139402	7.65	0.0792						
323854	94139402	6.98	0.0354						
323855	94139402	7.22	0.0177						
323856	94139402	7.86	0.0255						
323857	94139402	6.68	0.0213						
323858	94139402	6.22	0.0036						
323859	94139402	6.14	0.0027						
323860	94139402	5.80	0.0015						
323861	94139402	6.26	0.0039						
323862	94139402	5.48	0.0057						
323863	94139402	5.30	0.0012						
323864	94139402	5.16	0.0006						
323865	94139402	5.90	0.0057						
323866	94139402	6.72	0.0060						
323867	94139402	5.96	0.0114						
323868	94139402	6.14	0.0156						
323870	94139402	6.76	0.0147						
323871	94139402	6.36	0.0096						
323872	94139402	5.54	0.0546						
323873	94139402	6.54	0.0219						
323874	94139402	4.76	0.0231						
323875	94139402	5.84	0.0063						
323876	94139402	6.18	0.0042						
323878	94139402	5.24	0.0213						
323879	94139402	6.66	0.0056						
323880	94139402	4.30	0.0051						
323881	94139402	5.74	0.0056						
323882	94139402	5.28	0.0054						
323883	94139402	6.12	0.0036						
323884	94139402	5.18	0.0006						
323885	94139402								

CERTIFICATION: *[Signature]*

ALS Chemex

Almet Laboratory Services Ltd
 Analytical Chemistry - Geochemistry - Registered Analysts
 212 Brackley Ave. North Vancouver BC V7J 2G1
 British Columbia, Canada
 PHONE: 604-654-0271 FAX: 604-654-0710



To: PACIFIC GOLD INC
 1600 - 1168 ALBERTA ST
 VANCOUVER BC
 V6E 2Z3

Page Number: 1.4
 Total Pages: 1
 Certificate Date: 14-NOV-01
 Invoice No.: 10127973
 P.C. Number:
 Account:

Project: BLACK DOME
 Customer: ATTN: MICK FERRE
 CC: MARVIN MITCHELL

CERTIFICATE OF ANALYSIS A0127973

SAMPLE	PREP CODE	Aq Tot. g/L	Au-dVg g/L	Au + mg	WC grams	WT + grams	Au -(1) g/L	Au -(2) g/L
323825 RESPLIT	3288 277	4.93	0.20	0.698	1059	5.27	4.33	4.25
323826 RESPLIT	3288 277	3.82	2.16	1.731	1048	5.83	2.30	2.05
323834 RESPLIT	3288 277	10.07	7.43	2.653	1002	5.68	7.27	7.58
323835 RESPLIT	3288 277	2.58	1.19	1.347	941	2.30	1.20	1.18
323841 RESPLIT	3288 277	0.33	0.27	0.056	888	5.34	0.30	0.24
323842 RESPLIT	3288 277	0.17	0.14	0.032	947	3.60	0.14	0.14
323843 RESPLIT	3288 277	1.05	0.80	0.225	870	2.40	0.79	0.82
323844 RESPLIT	3288 277	16.65	0.91	9.642	943	2.39	6.88	0.13
323849 RESPLIT	3288 277	0.35	0.37	0.024	927	4.04	0.30	0.44
323850 RESPLIT	3288 277	0.13	0.12	0.083	884	4.13	0.18	0.13
323853 RESPLIT	3288 277	5.26	1.67	1.552	1818	5.50	1.78	3.64
323854 RESPLIT	3288 277	0.61	0.40	0.111	951	3.60	0.48	0.49

RECEIVED LABS 11/14/01

PAGE 002

APPENDIX B

1 :400 SCALE
1920 PORTAL
DUMP
SEE SHEET
TO NORTH
MILL RAMP



1960N 1:400
DUMP



1960
N
PORTAL

535558
5685928

□ PIT 2
535597
5685913
□ PIT 1
535588
5685890

19605
DUMP

400
SCALE



19605
PORTAL



PIT 6
5285304
535304
PIT 7 6585297
535313

PIT 10
535281
5285287

PIT 5
5285287
535306

PIT 9
535278
5285263

PIT 4
5285294
535306
PIT 8
5285278
535311

PIT 3
5285261
535308

Road
PIT 1
5685196W
535302E
PIT 2
5685228
535308E

SCALE 1:400

CRUSHER
RAMP

CRUSHER
5605
534647 1920 ALT

NOTE
DIR OF
ARROW

PIT 1
5685438
534646

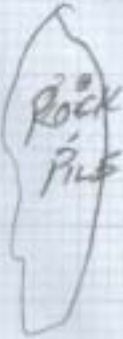

PIT 2
5605410
534642

Rock.

1:400

PIT 3
534640
5305382

534640
5305382

CAN'T DIG
100
HARD

GENERATOR
AREA

PIT 1
□ 534184
□ 5865328

PIT 2
534178
□ 5685320

PIT 6
534174
□ 5685333

PIT 3
□ 534169
5685326

ROAD

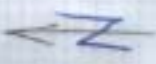

PIT 5
534157
□ 5685340

PIT 4
□ 534156
5685332

ABOVE CAMP

1:400

MILL RAMP SEPT 26

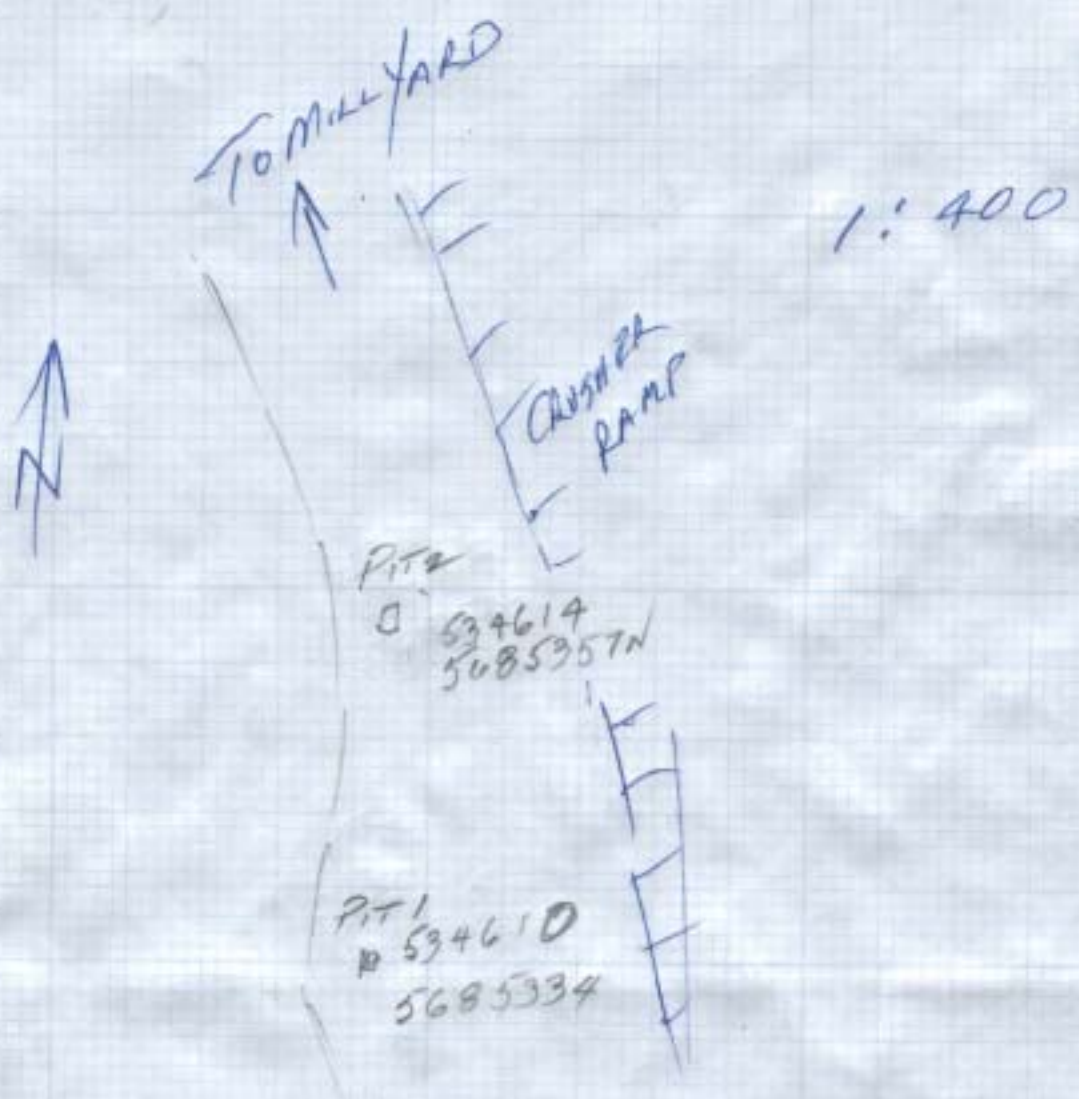

1:400 SCALE
REBARO
DUMP

SHEET 1

585596
5686942
2110 EL

SLOPE OF HILL

ROAD

WASTE

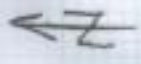
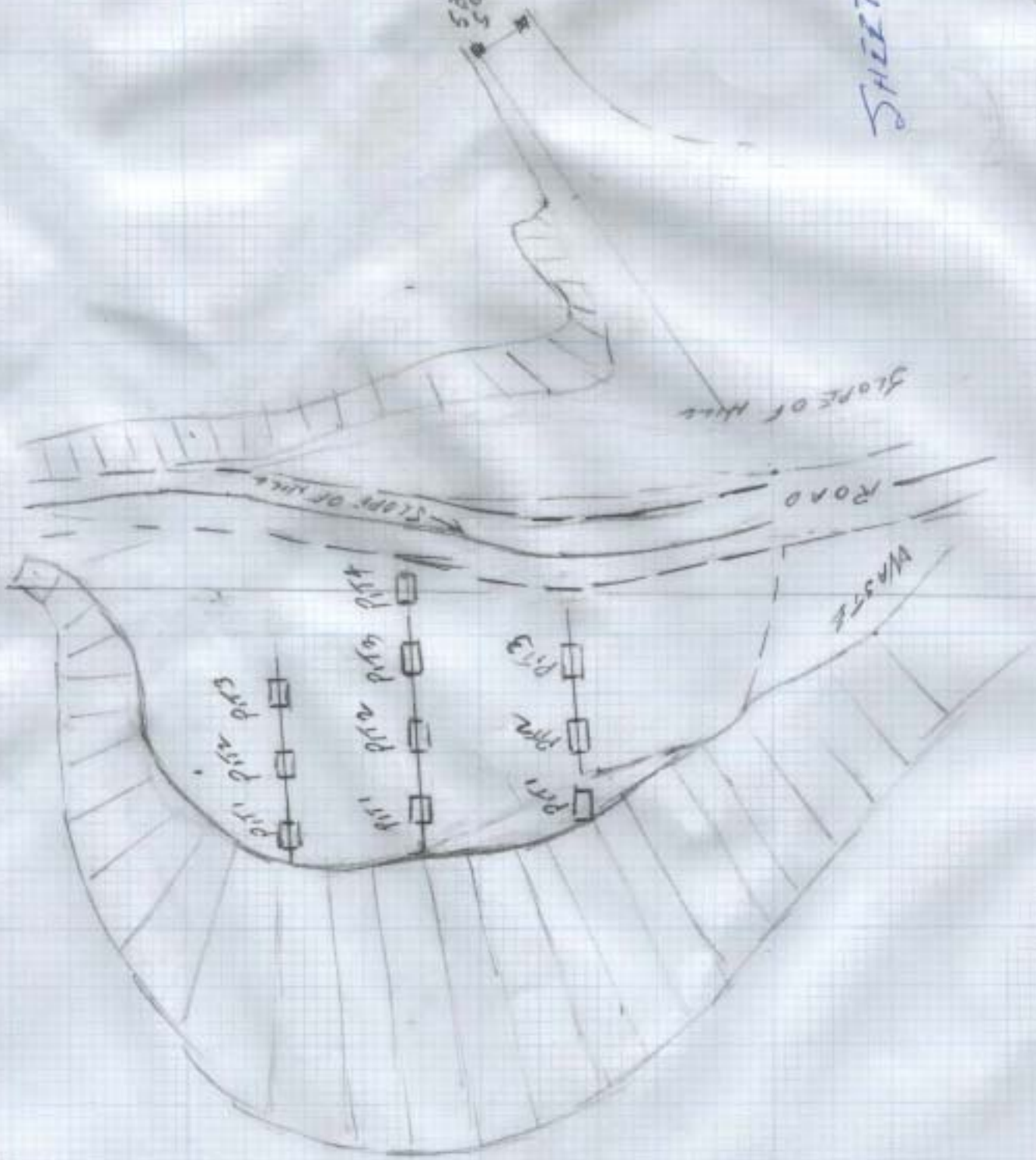

SECTS
LOOKING N

SHEET
2

